

UPDATED 3/15

120-13 LED

120-16 LED

120-24 LED

LUMINOUS BOWL

Design
Sustainability
Value



120-16 shown in Satin Aluminum



print this page



email this page to a colleague



installation instructions



interactive submittal drawing

COMPANION

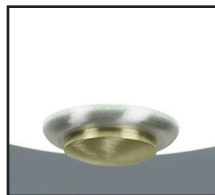

FEATURES

- Simple shallow bowl design.
- T-5 circline lamps provide uniform luminosity.
- Available in three sizes.
- Tool-free relamping.

ECO INFO

METALS: Aluminum and brass with the highest available recycled content for lower embodied energy. Both metals are valuable and recyclable at the end of the product's useful life. For more information see "GENERAL INFO"

FINISHING: Aluminum and Antique Brass finishes are sealed with a hand-applied bees wax. No paint or lacquer is used in order to avoid pollution associated with the manufacture and application of these substances. Satin Brass is clear-coated with a very low VOC water-based coating. Paint finishes are low VOC and oven cured.

ENERGY: Designed exclusively for circline fluorescent lamps using HPF electronic ballasts or LEDs.

MATERIALS

- Solid brass or aluminum metal work, hand finished
- Luminous bowl is white acrylic with a matte finish.

FINISHES

SAL Satin Aluminum

AB Antique Brass

SB Satin Brass

CCP Custom Color Painted

Standard metal finishes are hand satined and either waxed or sealed with a water-based clear coat. Other metal finishes are available. Contact factory.

LAMPING

CF: 120-13: 1-T5 22W Circline

120-16: 1-T5 40W or 55W Circline

120-24: 4-CF27 or 39W, 2G11 base.

Lamp not included.

LED: 120-13 & 120-16: 2-GU24 base LED A-lamps, 12W,

1100 lumens each, 3000K, supplied.

120-24: 3GU24 base LED as above.

BALLAST/DRIVER

CF: Integral electronic HPF, 120V/277V.

LED: Electronic driver is built into the lamp, 120V only.

Dimmable to 10% with most incandescent dimmers.





120-16 Shown with EBP and collar.

120-13
120-16
120-24

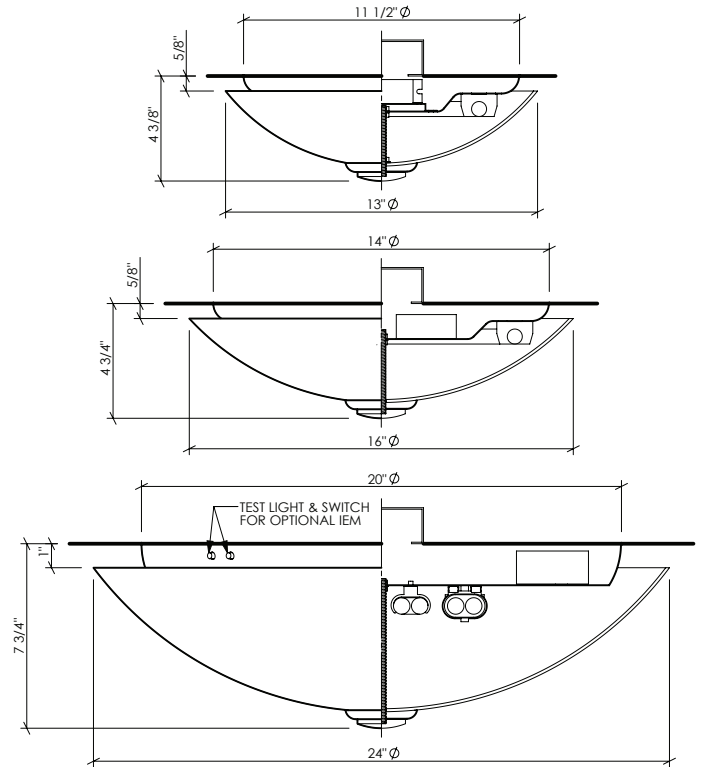

OPTIONS

FAUX: Hand applied faux alabaster finish available, specify **FAUX**.

DIMMING: **CF:** Electronic dimming ballast available.

LED: Triac dimmable to 10%.

EMERGENCY BATTERY PACK: Integral **EBP** with addition of 1 1/4 inch deep collar available for 120-16. (No collar required for 120-24.) Specify **IEM**. For 120-12 **EBP** is remote mounted. Specify **REM**. Not available for **LED**.



PHOTOMETRICS

Use Lighting Sciences Report 22410 for the model 106.

Fixture Efficiency: 80.6%

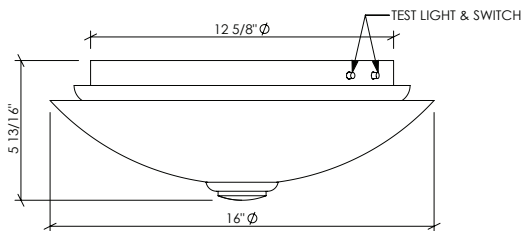

EBP CONFIGURATION

MOUNTING: Standard J-box or plaster ring.

WEIGHT: 120-13: 3 lbs
 120-16: 4 lbs
 120-24: 6 lbs

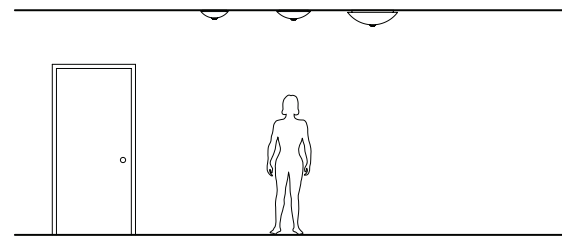

VARIATIONS / MODIFICATIONS

- Special finishes
- Addition of decorative detail
- Different bowl size

SPEC GUIDE SAMPLE SPEC: 120-16-T5/40-120-SAL-FAUX

CAT#	SIZE	LAMPING	VOLT	FINISH	OPTION
<input type="checkbox"/> 120	<input type="checkbox"/> 13	<input type="checkbox"/> T5/22	<input type="checkbox"/> 120	<input type="checkbox"/> SAL	<input type="checkbox"/> FAUX
	<input type="checkbox"/> 16	<input type="checkbox"/> T5/40	<input type="checkbox"/> 277	<input type="checkbox"/> AB	<input type="checkbox"/> IEM
	<input type="checkbox"/> 24	<input type="checkbox"/> T5/55		<input type="checkbox"/> SB	<input type="checkbox"/> REM
		<input type="checkbox"/> CF4/27		<input type="checkbox"/> CCP	<input type="checkbox"/> DIM
		<input type="checkbox"/> CF4/39			
		<input type="checkbox"/> LED2/12			
		<input type="checkbox"/> LED3/12			



LIGHTING FIXTURES



Our fixtures are handcrafted here in the USA using the highest quality materials.

